



435

MARKETING BOOK_US_2024



SUMMARY



- SPECIFICATIONS
- CONCEPT
- KEY POINTS
- EXTERIOR
- INTERIOR
- ATMOSPHERE
- ELECTRONIC PACKAGES
- TECHNICAL DATA
- COMPETITION

SPECIFICATIONS



OVERALL LENGTH : (w. Outboards and Anchor)	43'11"	13,40 m
HULL LENGTH:	39'2"	11,95 m
BEAM :	12'6"	3,82 m
DEADRISE;	19,5°	
LIGHT DISPLACEMENT: (w. 3x350 Ooutboards)	23 128 lbs	10 491Kg
DRAFT OB UP :	2'8"	0,83 m
DRAFT OB DOWN:	3'11"	1,2 m
AIR DRAFT: (Waterline to top of roof w. no equipment)	14'11"	4,55 m
AIR DRAFT: (Waterline to the top of antennas (optional))	17'11"	5,45 m
WATER CAPACITY :	66 US GAL	250 L
FUEL CAPACITY :	340 US GAL	1.290 L
MAX ENGINE POWER :	1.050 HP	
EC CATEGORY:	B10 / C12	
DESIGNERS :	Garroni Design / Michael Peters	

Wellcraft®

CONCEPT

Bigger & Bolder

Built for all **adventures and types of weather**, the Wellcraft 435 was designed by the famed Garroni Studio in Italy and the highly recognized American naval architect Michael Peters.

Powered with **triple outboard engines totaling over 1.000hp**, equipped with an impressive pilot station, highly responsive controls and exceptional navigation systems, the Wellcraft 435 responds to the toughest demands and meets every challenge - **to go anywhere, to do anything.**

The Wellcraft 435 boasts **large exterior social areas** with an extendable aft cockpit and **fully equipped galley** making the layout perfect for easy movement while gathering with family and friends. Below deck are **two luxurious and spacious cabins with bathrooms** that each have separate showers to provide rich accommodations for up to five.

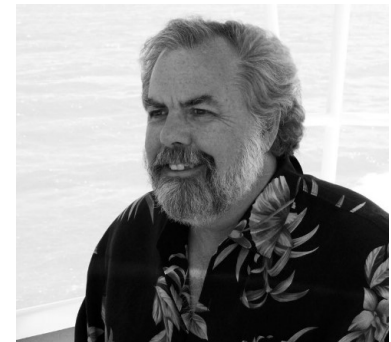

The Wellcraft logo, featuring a stylized 'W' with a red and blue vertical bar to its left, followed by the word 'Wellcraft' in a bold, sans-serif font with a registered trademark symbol.

KEY POINTS

- Life on board is easy and safe with **all comfort for coastal cruising and safe offshore passages**
- **Very protected wheelhouse** with three pilot and co-pilot seats, fully equipped galley on deck level with seamless connection to the aft cockpit
- **Two lateral folding side terrasses** for easy access to the water
- A big social area in the bow with a **huge tripple sunlounger and vis-à-vis sitting**
- **Two cabins** (Master + VIP) and two bathrooms with **separate shower**

HIGHLIGHTS



 **Wellcraft®**

EXTERIOR

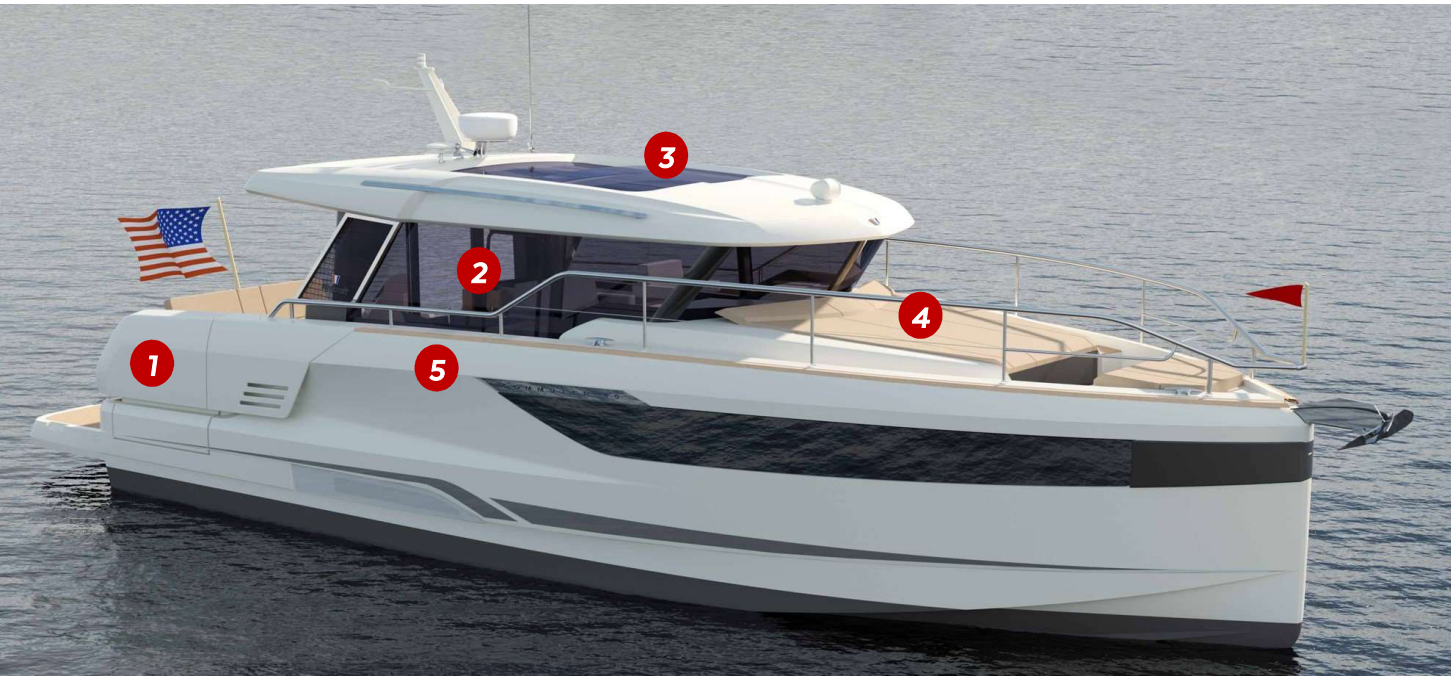

- 1 Lateral swim platform
- 2 Lateral sliding door

- 3 Electric opening WEBASTO sunroof
- 4 Front sundeck with bench seat in front
- 5 Side Gate

EXTERIOR

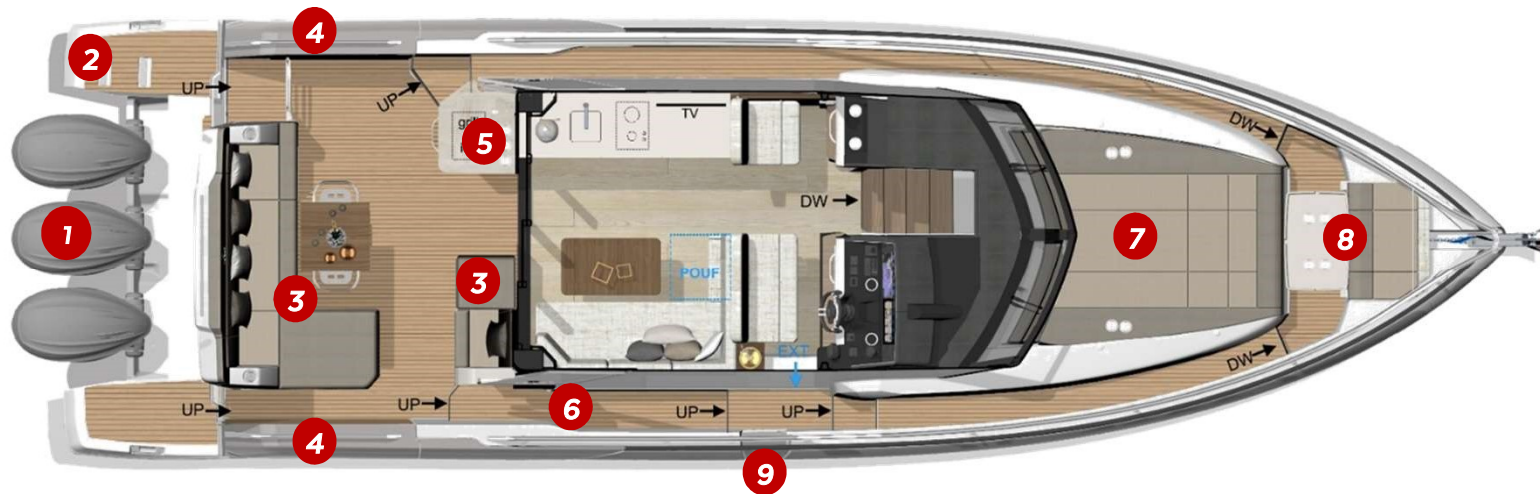

1 3 x 350hp V10 Mercury Verado

2 Aft security ladder

3 L-shape cockpit bench + aft and stool

4 Big lateral side platforms

5 Galley module (Options: 2nd Fridge or Icemaker / BBQ elec.)

6 Asymetric deck layout with safe passage on starboard

7 Front sundeck with cup holders and flip up backrest for front seating

8 vis-à-vis seating with optional table

9 Side gate

EXTERIOR



 **Wellcraft®**

EXTERIOR

COCKPIT DIMENSIONS

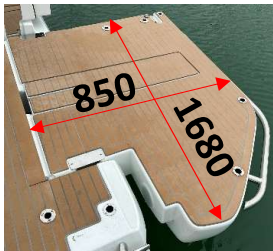
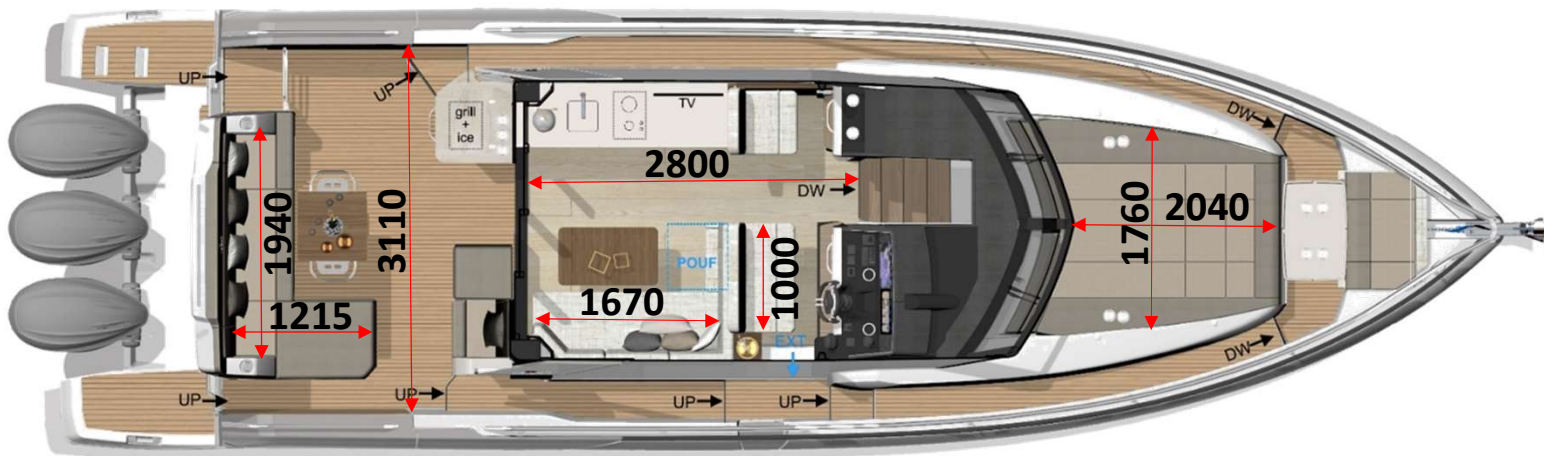

EXTERIOR

ELECTRIC FOLDING SIDE TERRACES (Standard)

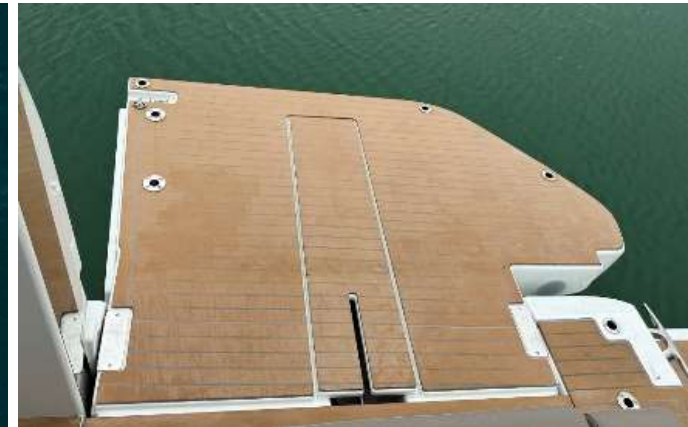

EXTERIOR

ELECTRIC FURLING SUN PROTECTION (Option BE_C40)





EXTERIOR

BOW SUN SHADE (Option BE_DA825)



EXTERIOR

FULL AFT COCKPIT ENCLOSURE (Option)



Table (Option BE_T510P)



EXTERIOR

LIGHTS



LED LIGHTBAR (Option FN_B11)



DECK SEARCHLIGHT
(Option FN_B03 ou RN_B24PP ou RN_B17PP)



4 RGB LUMISHORE
UNDERWATER
LIGHT: AFT AND
SIDES (Option FN_B15)

EXTERIOR

ELECTRIC SLIDING ROOF (Standard)



Mosquito



Heat protection



INTERIOR



© ATM-Communication

 Welcraft®

INTERIOR WHEELHOUSE

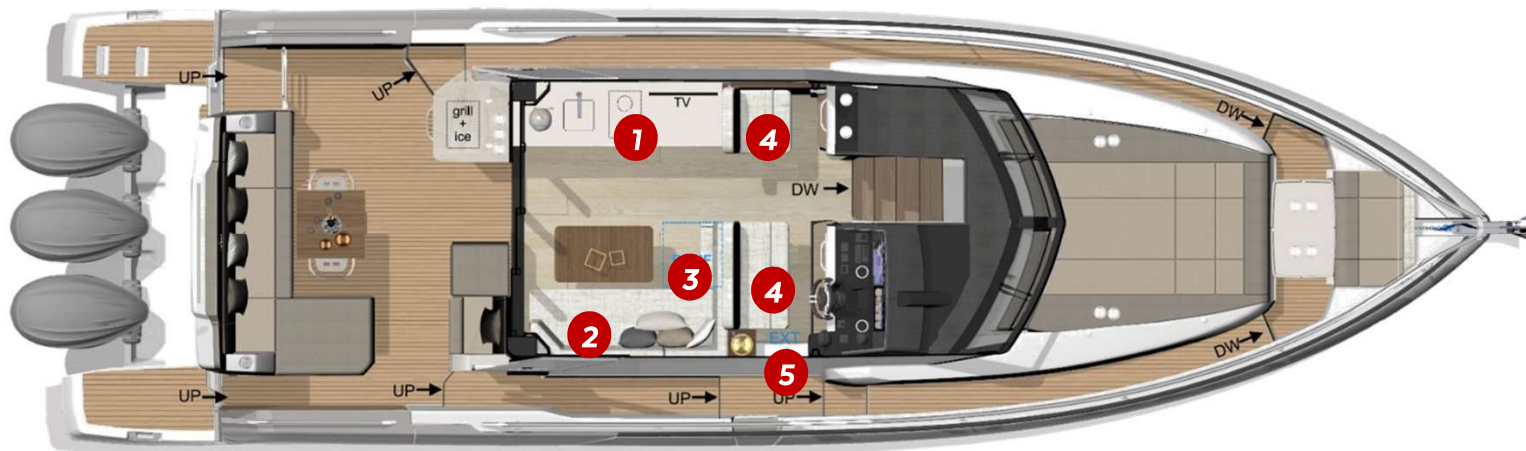

- 1 Full equipped galley
- 2 Sofa 3 seats
- 3 Removable stool
- 4 Pilot & Co pilot bench
- 5 Lateral sliding door



INTERIOR CABINS

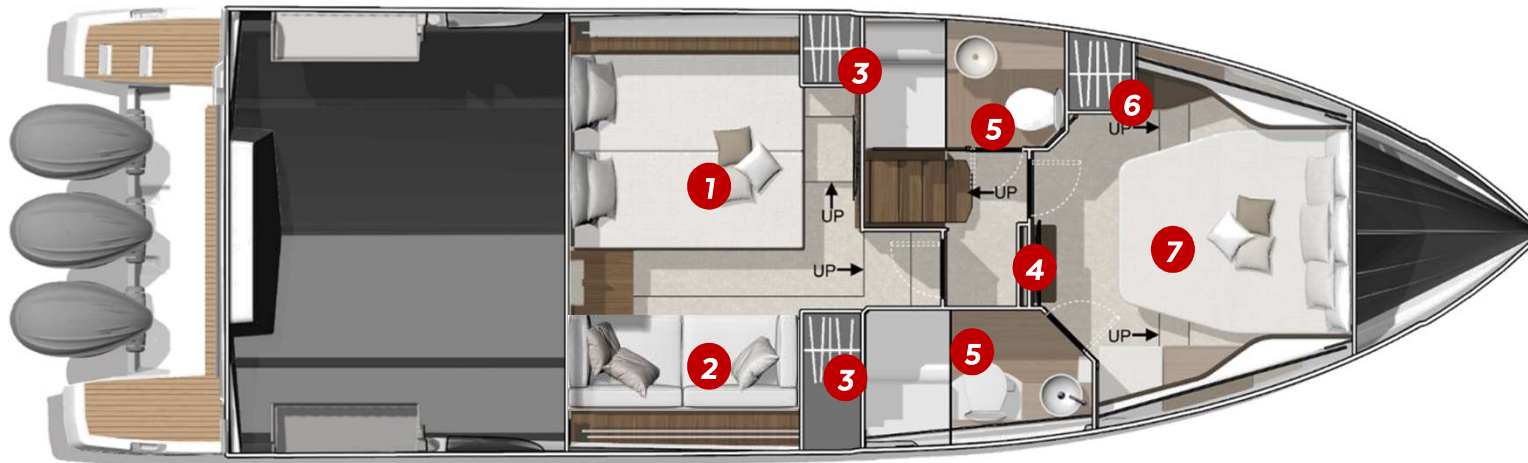

- 1 Double bed with big storage underneath
- 2 Sofa with storage underneath
- 3 Closet on each side
- 4 Electric panel
- 5 2 heads with separate shower
- 6 Closet
- 7 Double bed with storage underneath

INTERIOR

BERTH DIMENSIONS

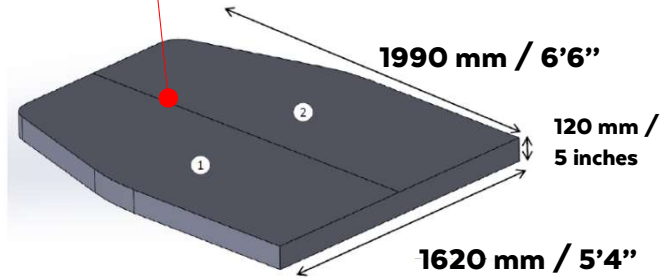
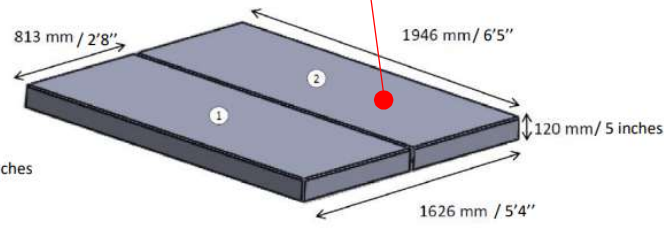
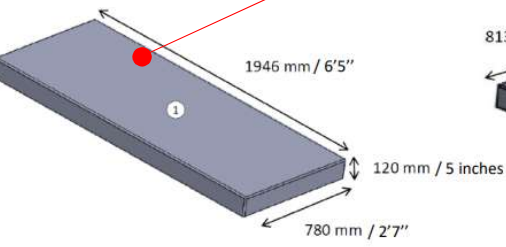
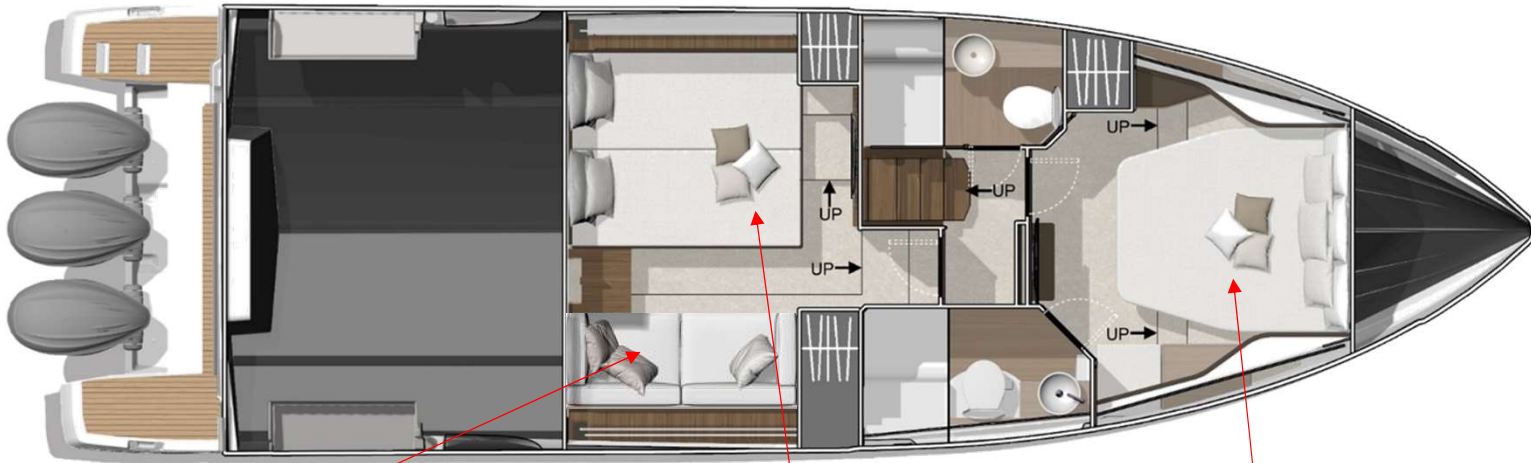

INTERIOR

Mattress Dimensions Master Cabin

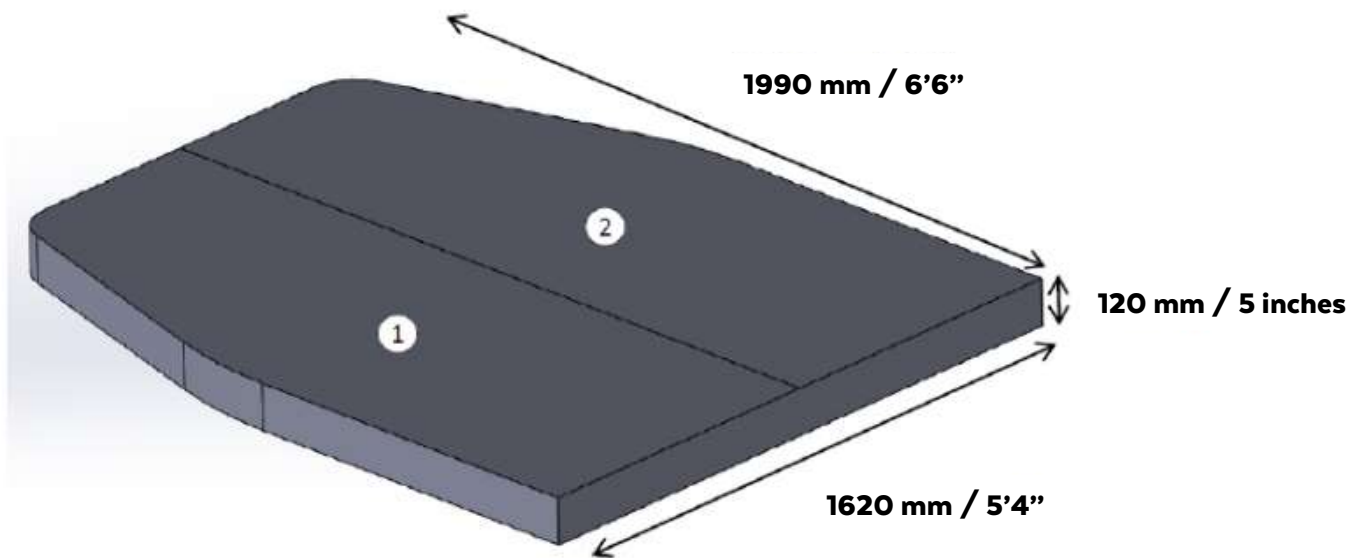

INTERIOR

Mattress Dimensions VIP Cabin

Mattress single bed starboard

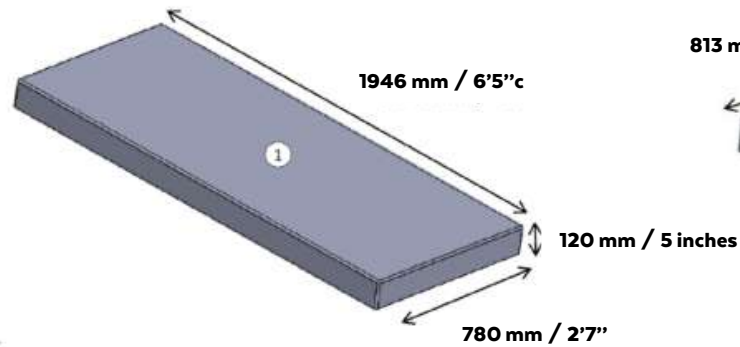

Mattress double bed portside

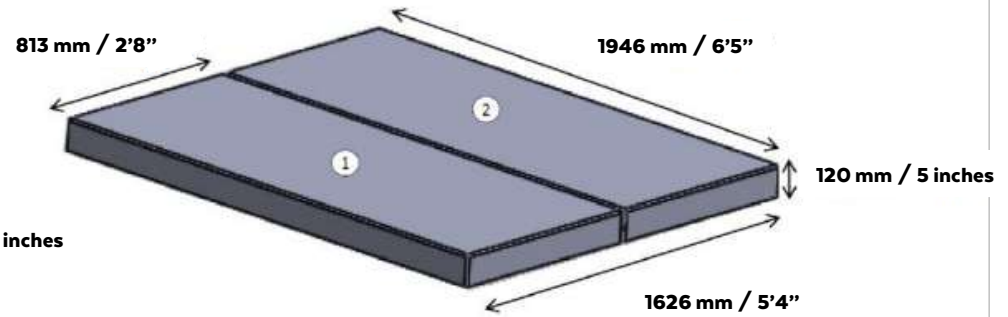

INTERIOR

WHEELHOUSE

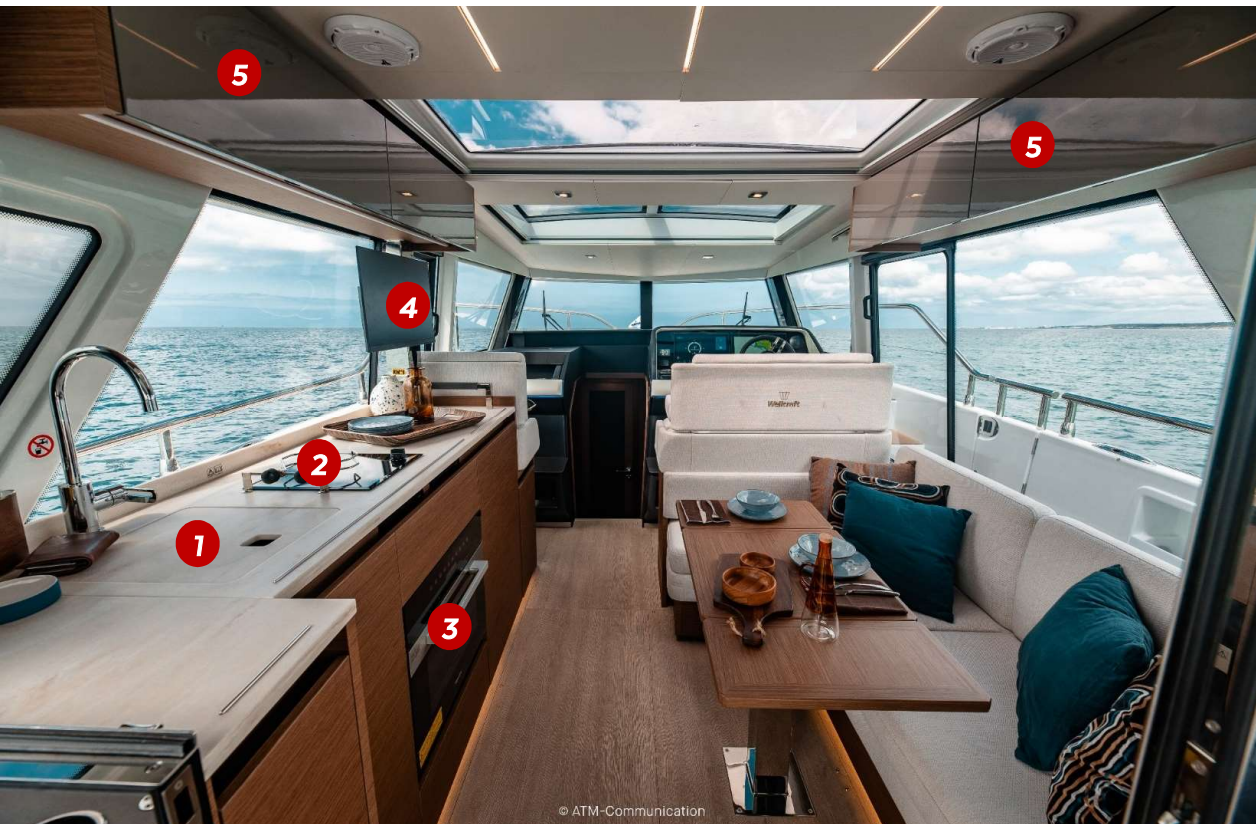

- 1 Sink
- 2 Vitroc ceramic cooktop
- 3 Microwave oven
- 4 TV (Option)
- 5 Laquered overhead lockers
- 6 Foldable, fixed salon table

INTERIOR

HELM STATION



- 1 Mercury joystick
- 2 Bow thruster
- 3 Multifunctional steering wheel
- 4 16" Garmin screens
- 5 Blue ambient lights

INTERIOR

HELM STATION

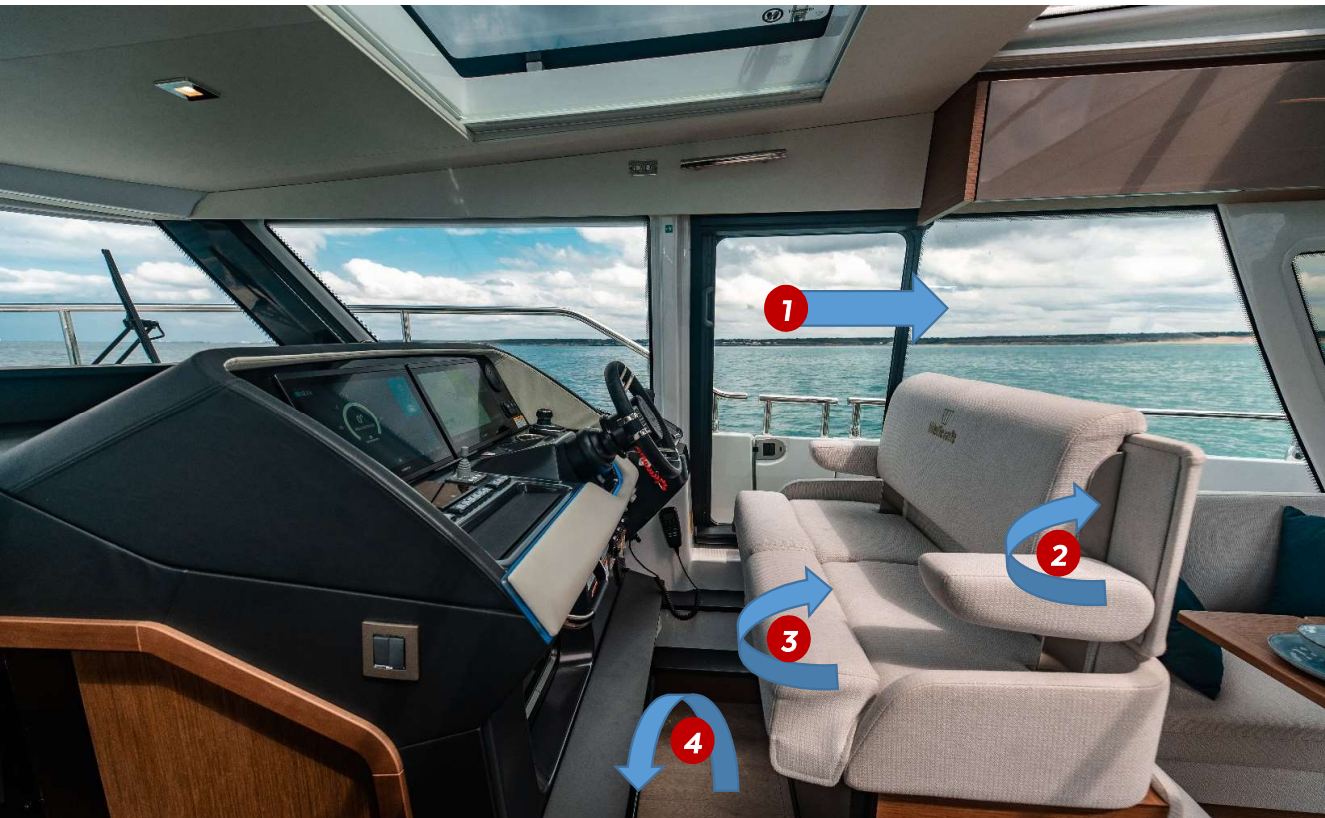

- 1 Siding side door / window
- 2 Folding armrests
- 3 Flip Up bolster
- 4 Fold down steps (Pilot/Copilot)

INTERIOR

MASTER CABIN

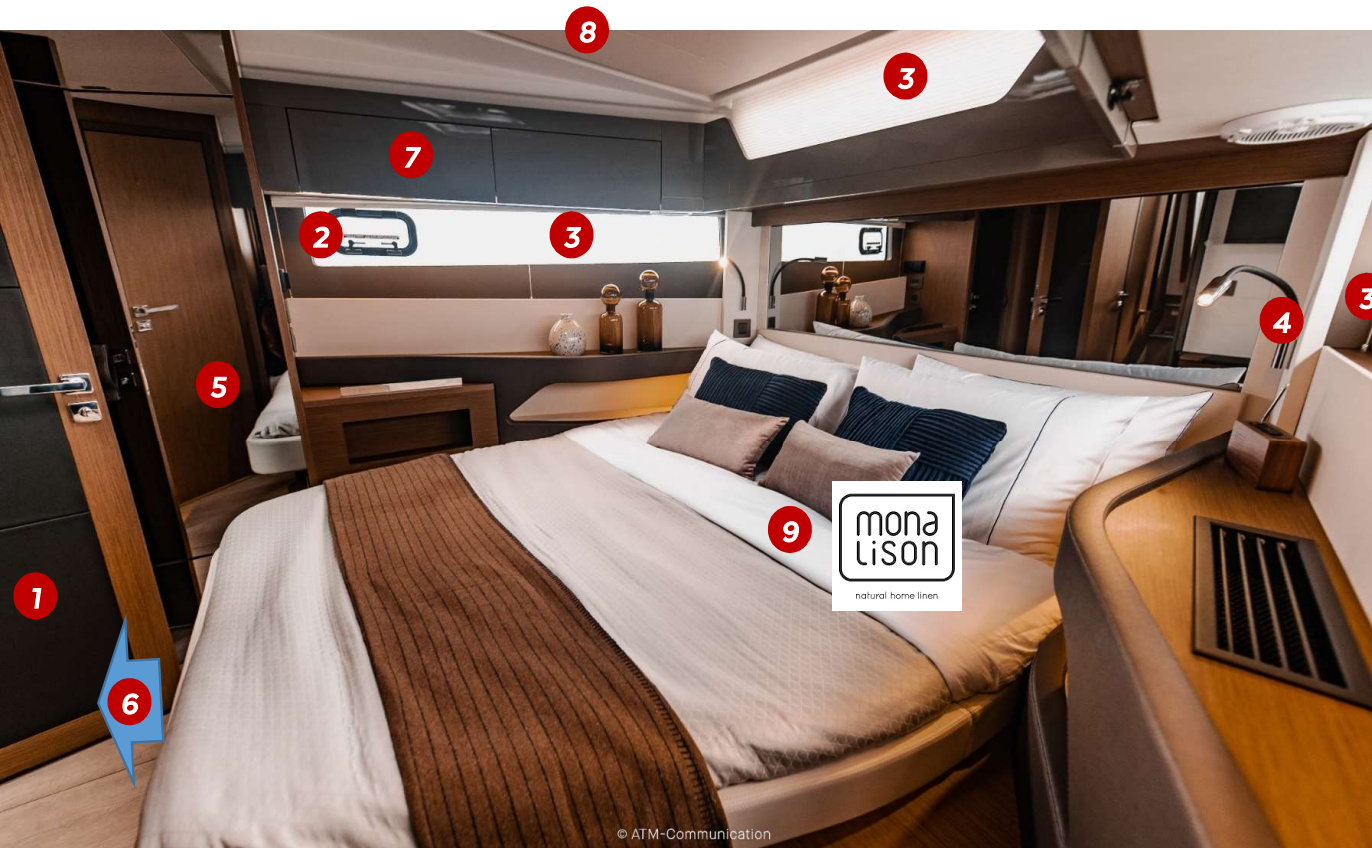

- 1 Double side leather covered door
- 2 Port and starboard openable portlights
- 3 Shades for privacy (3)
- 4 Reading lights with USB ports (2)
- 5 Wardrobe with full height mirror
- 6 Storage drawer under the bed
- 7 Laquered overhead lockers (4)
- 8 Ventilation deck hatch with mosquito and heat protection shade
- 9 MONALISON bed linen (600TC) and cushions (Option)

INTERIOR

VIP CABIN



- 1 Drawer
- 2 Sofa
- 3 Shades for privacy (2)
- 4 Reading lights with USB ports (3)
- 5 Wardrobe port and starboard (2)
- 6 Big storage under the bed
- 7 Laquered overhead lockers (4)
- 8 Ventilation port lights (2)
- 9 MONALISON bed linen (600TC) and cushions (Option)

INTERIOR

MASTER CABIN HEAD



- 1 Storage
- 2 Seat in separate shower
- 3 Corian worktop and shower grating
- 4 Aluminum Venetian Blinds
- 5 Ventilation portlights (2)

Welcraft®

INTERIOR

DAY HEAD

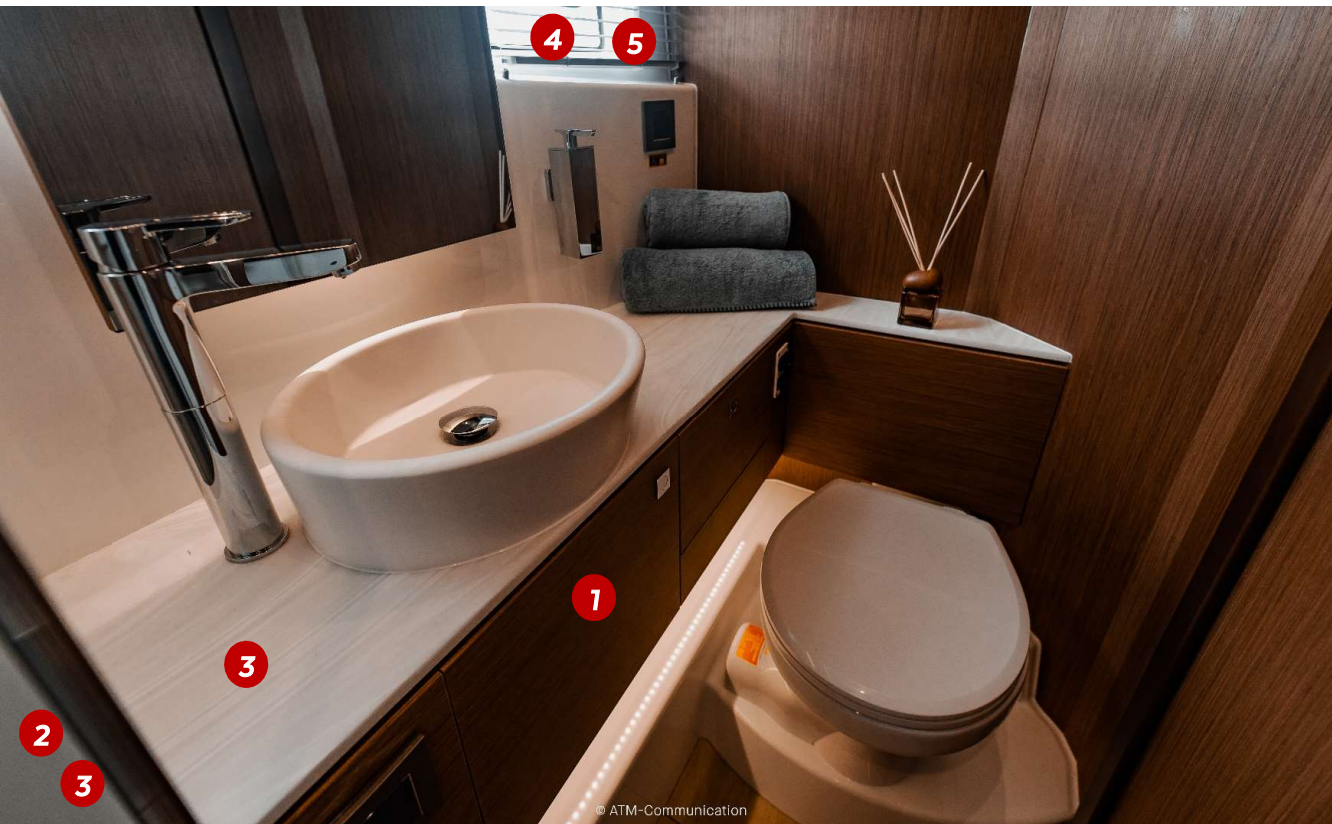

- 1 Storage
- 2 Seat in separate shower
- 3 Corian worktop and shower grating
- 4 Aluminum Venetian Blinds
- 5 Ventilation portlights (2)

INTERIOR

VENTILATION

Wheelhouse



Master Cabin



VIP Cabin



Master Head



VIP Head



INTERIOR

AIR* CONDITIONING REVERSIBLE - 40K BTU

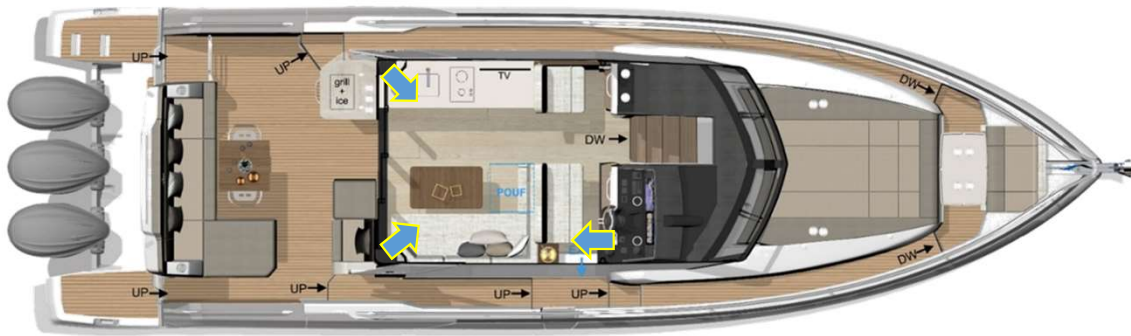

16K BTU + 4K BTU (partially coming from aft cabin unit)



12K BTU (sharing 4KBTU with helm) + **12K BTU**

EXTERIOR

STANDARD FABRICS (No Options)



SPRALDING
LINETEX GREY



SPRALDING
LINETEX BEIGE



INTERIOR ATMOSPHERE

STANDARD (No Options)



STERLING UPHOLSTERY



ROVERE



CARPET (Option)



WALNUT FURNITURE



INTERIOR ATMOSPHERE



natural home linen

MONALISON BED LINEN (Option: II_IO2)

Cabine Master

- 1 Drap-housse sur-mesure blanc 164 x 200 cm
- 1 Housse de couette blanche uni - 220 x 230 cm
- 2 Taies d'oreiller blanches + passepoil bleu tout le tour - 50 x 80 cm
- 2 Taies d'oreiller blanches + biais bleu - 50 x 80 cm
- 1 Couette été en coton 200 g/m² - 220 x 230 cm
- 4 Oreillers laine mérinos, 1000 g/m² - 50 x 80 cm
- 2 Coussins décoratifs 40 x 40 cm
- 1 Coussin décoratif
- 1 Couvre-lit 220x200 cm

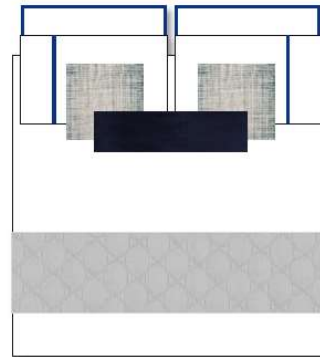

Cabine VIP

- 1 Drap-housse sur-mesure blanc 161 x 194 cm
- 1 Housse de couette blanche uni - 220 x 230 cm
- 2 Taies d'oreiller blanches + biais bleu - 50 x 80 cm
- 1 Couette été en coton 200 g/m² - 220 x 230 cm
- 2 Oreillers laine mérinos, 1000 g/m² - 50 x 80 cm
- 1 Coussin décoratif
- 1 Couvre-lit 220x200 cm

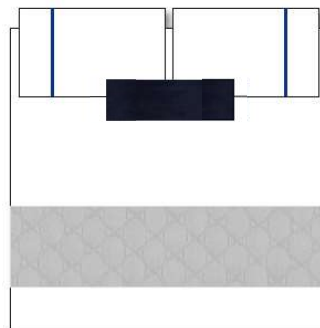

INTERIOR ATMOSPHERE

VIP CABIN



1 Drap-housse blanc
Entièrement élastiqué
100% satin de coton 600 TC
161 x 194 cm, bonnet 20 cm

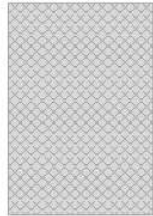

1 Couvre lit sur-mesure en coton gris
piqué losanges
Elastiqué au pied du lit
100% coton
Pour lit double, 220 x 200 cm



1 Couette été en coton 200 g/m²
Enveloppe 100% coton
Garnissage 100% coton
220 x 230 cm

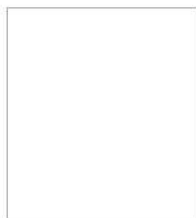

1 Housse de couette bio blanc uni
100% satin de coton 600 TC
220 x 230 cm

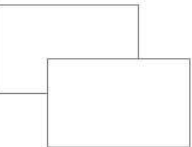

2 Oreillers en laine 1000 g
Enveloppe 100% coton
Garnissage 100% laine naturelle
de mérinos, non teint, non carbonisé
50 x 80 cm



2 taies d'oreillers blanches avec
passepoil sur côté gauche ou
droit
100% satin de coton 600 TC
50 x 80 cm



1 Coussin décoratifs
100% coton
30 x 50 cm

MASTER CABIN



1 Drap-housse blanc
Entièrement élastiqué
100% satin de coton 600 TC
164 x 200 cm, bonnet 20 cm



1 Couvre lit sur-mesure en coton beige
piqué losanges
100% coton
Pour lit double, 220 x 200 cm



1 Couette été en coton 200 g/m²
Enveloppe 100% coton
Garnissage 100% coton
220 x 230 cm

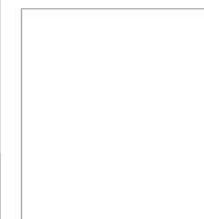

1 Housse de couette bio blanc uni
100% satin de coton 600 TC
220 x 230 cm

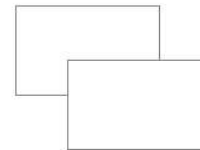

4 Oreillers en laine 1000 g
Enveloppe 100% coton
Garnissage 100% laine naturelle
de mérinos, non teint, non carbonisé
50 x 80 cm



2 taies d'oreillers blanches avec
passepoil sur côté gauche ou
droit
100% satin de coton 600 TC
50 x 80 cm



2 Coussins décoratifs
100% coton
40 x 40 cm



2 taies d'oreillers blanches avec
passepoil tout autour
100% satin de coton 600 TC
50 x 80 cm



1 Coussin décoratifs
100% coton
30 x 70 cm



natural home linen

HULL PAINT

AWLGRIP®

OPTION

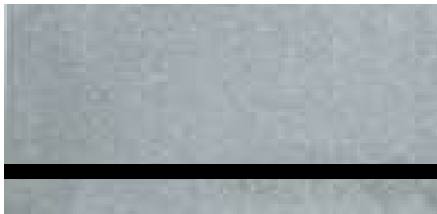

**Crystal Silver Metallic
E1009**

**Blue Steel Metallic
E5013**

**Mid Atlantic Blue Metallic
E5009**

**Tourmarine Blue Metallic
E5006**

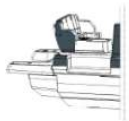
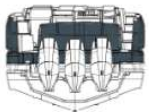
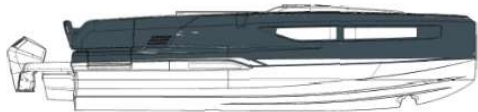
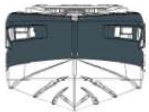

31,01 sq Yards /37,1m²

Wellcraft®



ELECTRONICS - USA



ELECTRONIC PACK – P_R9EU (USA)



2x GPSMAP 8416/8416xsv
2x MFD with multitouch 16" screen and integrated 1kW Dual-CHIP Sonar



OPTION BLACK-BOX VHF RADIO (US VERSION)

VHF 315
Black-box VHF radio (1W / 25W)
with GHSII handset microphone



OPTION AIS TRANSDUCER (VHF ANTENNA IS REQUIRED)

AIS 800
AIS Transceiver (Built-in GPS
and VHF antenna splitter)



Garmin GT15M-IH
Mid-Band CHIRP Traditional
Depth and Temperature



+ SHIP CONTROL



ELECTRONICS



OPTION
DOME RADAR

On Mast*

GMR FANTOM 18x
18-inch, 50 W solid-state dome radar
with MotionScope Technology



OPTION
OPEN ARRAY RADAR

On Mast*

GMR Fantom 54
4' antenna, 50 W solid-state, open array
radar with MotionScope Technology



2x Dummy Domes



SEAKEEPER

Is available either...

1. with Generator and 2x60AMP Chargers
and/or

2. with Lithium Ion Battery Pack for *Silent Ship Mode*.

1.

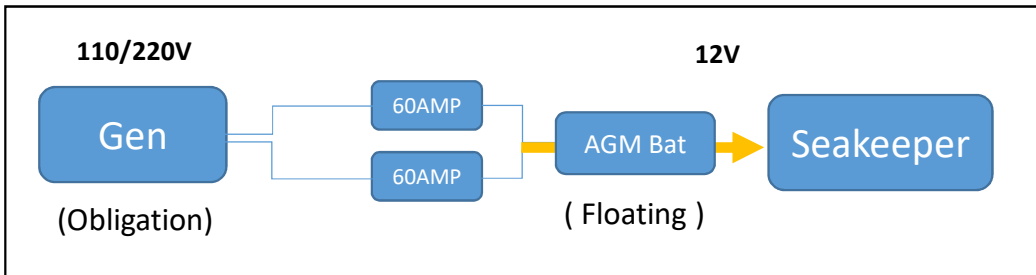

2.

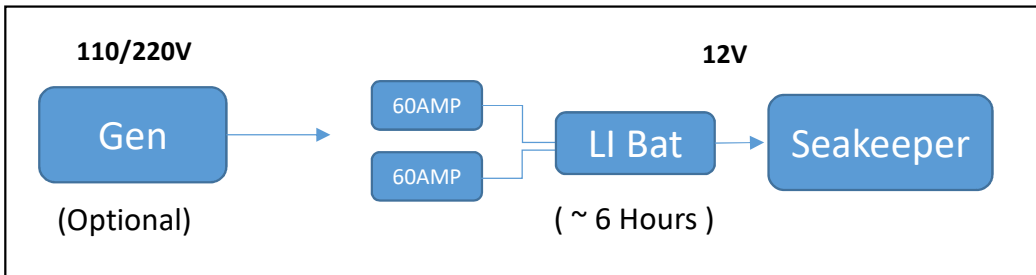

SEAKEEPER

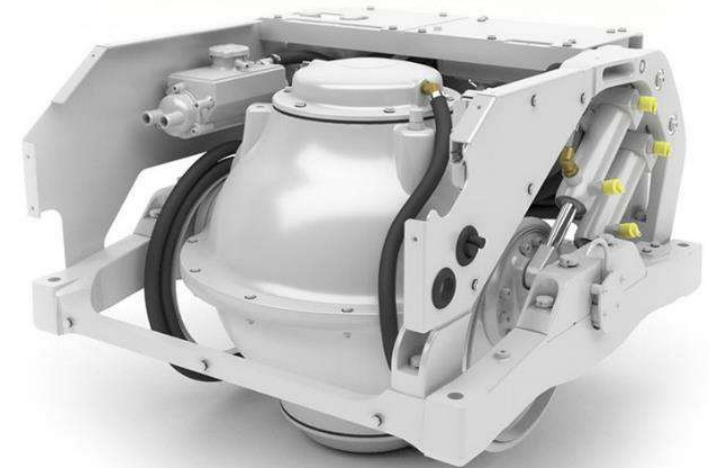



PERFORMANCE DATA

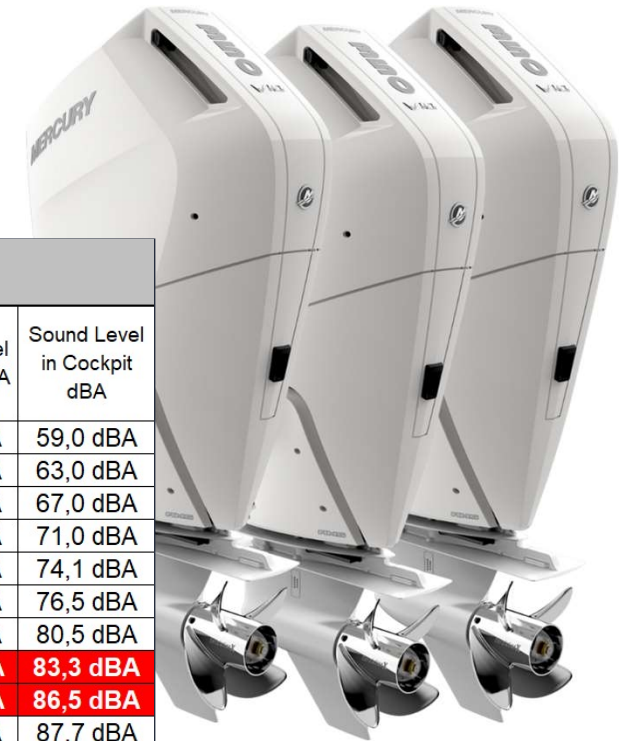

3x350 V10 @ 13.108 KG

RPM	Average GPS Speed in knots	Average GPS Speed in miles	L/H	L/ NM	US Gal/ SM	Autonomie SM with 10% Reserve	Sound Level Front Cabin dBA	Sound Level Aft Cabin dBA	Sound Level @ Helm dBA	Sound Level in Cockpit dBA
600	3,60 Nds	4,1	11,70 l	3,25l/miles	0,86	330,77	53,0 dBA	56,0 dBA	53,0 dBA	59,0 dBA
1000	5,20 Nds	6,0	19 l	3,67l/miles	0,97	319,28	54,0 dBA	57,2 dBA	53,7 dBA	63,0 dBA
1500	7,50 Nds	8,6	30,00 l	4,00l/miles	1,06	293,18	55,2 dBA	60,7 dBA	55,5 dBA	67,0 dBA
2000	8,85 Nds	10,2	47,60 l	5,38l/miles	1,42	218,04	58,4 dBA	62,0 dBA	57,7 dBA	71,0 dBA
2500	9,75 Nds	11,2	62,10 l	6,37l/miles	1,68	184,12	62,5 dBA	63,0 dBA	59,3 dBA	74,1 dBA
3000	10,75 Nds	45,2	93,15 l	8,67l/miles	2,29	135,34	64,3 dBA	66,3 dBA	63,0 dBA	76,5 dBA
3500	13,50 Nds	15,5	122,50 l	9,07l/miles	2,40	129,24	66,0 dBA	70,0 dBA	66,5 dBA	80,5 dBA
4000	20,25 Nds	23,3	156,40 l	7,72l/miles	2,04	151,84	68,6 dBA	74,2 dBA	70,2 dBA	83,3 dBA
4600	26,80 Nds	30,8	188,50 l	7,03l/miles	1,86	166,73	72,0 dBA	77,5 dBA	72,0 dBA	86,5 dBA
5000	31,20 Nds	35,9	253,00 l	8,11l/miles	2,14	144,62	75,0 dBA	80,0 dBA	74,5 dBA	87,7 dBA
5500	35,40 Nds	40,7	318,50 l	9,00l/miles	2,38	130,34	77,7 dBA	81,5 dBA	76,0 dBA	89,0 dBA
5900	38,00 Nds	43,7	350,00 l	9,21l/miles	2,43	127,32	78,4 dBA	82,0 dBA	78,0 dBA	91,0 dBA
6300	40,75 Nds	46,9	356,00 l	8,74l/miles	2,31	134,24	79,5 dBA	83,0 dBA	78,5 dBA	92,0 dBA

Acceleration:

0-20knts 8,3 sec

0-30knts 14,5 sec



Sound Level Rating:

Source: decibelpro.app

• A normal conversation: 60-70 dB

- Open office noise: 65-75 dB
- An alarm clock: 70-80 dB
- Washing machine: 70 dB
- Dishwasher: 70 dB
- Restaurant: 70-80 dB
- Vacuum cleaner: 60-80 dB



TECHNICAL DATAS

Bateaux / Boats	MOUILLAGE / ANCHORING							AMARRE / MOORING		PARE-BATTAGES / FENDERS	
	Code / Ref	Ancre / Anchor		Chaîne / Line		Chaîne / Line		Code / Ref	Désignation / Détail	Code / Ref	Désignation / Détail
Wellcraft 355	179845	16 kg	INOX	10 mm	32 m	45 m	18 mm	043145	4 x D16 L12000 Gris / Grey	189033	6 x 700 X D.250
Wellcraft 435	187165	20 kg	INOX	10 mm	32 m	45 m	18 mm	119857	4 x D18 L15000 Gris / Grey	189033	6 x 700 X D.250

TECHNICAL DATAS

Bateaux / Boats	Version	Longueur HT / Length overall (m)	Largeur HT / Width overall (m)	Hauteur Colisage / Height overall (m)	Poids est. / Est. Weight (kg)	Poids ber / Weight cradle (kg)	Longueur ber / Length cradle (m)	Largeur ber / Width cradle (m)
Wellcraft 355	HB	11,84	3,27	4,33	7317	210	6,76	2,1
Wellcraft 435	HB	13,40	3,82	4,16	14463	-	6,90	3,50

Poids des bateaux : moteur maxi inclus / Weight boats: with max. engine size



BRIDGE CLEARANCE



TRANSPORT

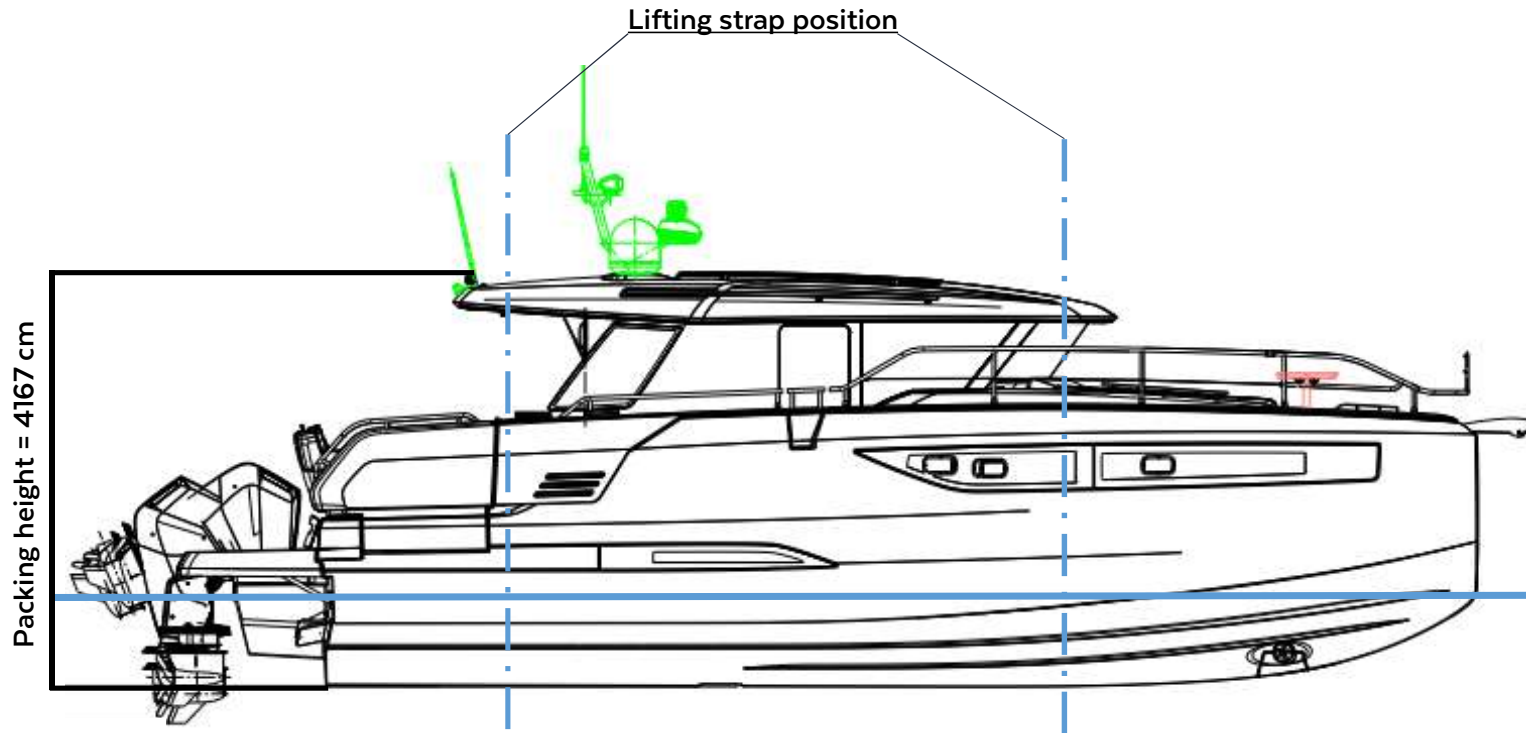



* **BURGEE ON MAST**
(Standard)

This document was updated in June 2023.
It may contain illustrations or text representing
or referring to optional equipment.
If changes appear on our 2023/2024 models,
with regard to equipment or options referred to in this document,
only the current Wellcraft rate will apply.

